

Customer w/Gallery



		
L220352A	TBD CR R, Moffat CO 81143	L \$109,000 <input type="checkbox"/>
 <p>© 2010 CCBOR</p>	Area: 7 - Out of County Subdiv: None Yr Built: Taxes Ann: 366 Flood Plain: No Schedule #: 460118300032	Tot Acres: 161.44 Year Rem/Adj: Tax Yr: 2009 Watershed: No
	Lot #: 3 and 4 Lot Dim: 2640x2640 Zoning: AGR	IDX: Yes Gate Key: Yes Internet Addr.: Yes Brochure Box: Yes Sign: Yes Prop Assoc: No Fin Int: No Com Split Cd: 3.2 EA: Yes HOA Fee: Filing #: n/a Improvements: Pond,Sheds,Fenced,Panels,Artesian w Covenants: No Lockbox: Yes Legal: Lots 3 and 4, E1/2 SW1/4 S18 T43N R10E
Special Features: Could be Divided , Horse Property , Mobile Homes Allowed , Modulares Allowed , Outbuildings , Perfect for Animals Utilities: Other-See Remarks Terms: Cash , New Loan Source of Measure: Public Records Lot Description: Level , Mountain Views , Pond		
Perm. Bk Rem: Directions: Hwy 17 south of Moffat to mile marker 103. West 3/4 mile to gate on right. Need LB code for gate.		
Remarks: 160 acre Colorado horse property 2 free flowing artesian wells and pond (unregistered);40 minutes to Salida or Alamosa;No covenants;Incredible mountain views;Incl 2 sheds,Conex unit,truck,tractor & implements;Fully fenced plus livestock panels;Power near;Close to hunting,skiing,National Forest.		
	Prepared by: Jon Adams Email : adams@firstcolorado.com	
	First Colorado Land Office Inc Off. Ph# : (719) 539-6682	
	PO Box 749 Agt. Ph# : (719) 207-3666	
	Salida, CO 81201 Cell Ph# : (719) 207-3666	
- - - Information herein deemed reliable but not guaranteed		

Photo Gallery MLS# [220352A](#)



--- Information is not guaranteed and should be verified ---
© 2006 Chaffee County Board of Realtors 08/16/2011 10:26 AM

Photo Gallery MLS# 220352A



- - - Information is not guaranteed and should be verified - - -
© 2006 Chaffee County Board of Realtors 08/16/2011 10:26 AM









Notes

Hwy 17 south of Moffat, CO at Mile Marker 103.

Map of:

Latitude: 37.96319 Longitude: -105.916401 Center, CO 81125



©2011 MapQuest, Inc. Use of directions and maps is subject to the MapQuest Terms of Use. We make no guarantee of the accuracy of their content, road conditions or route usability. You assume all risk of use. [View Terms of Use](#)



Notes

Hwy 17 south of Moffat, CO at Mile Marker 103.

Map of:

Latitude: 37.96319 Longitude: -105.916401
Center, CO 81125



©2011 MapQuest, Inc. Use of directions and maps is subject to the MapQuest Terms of Use. We make no guarantee of the accuracy of their content, road conditions or route usability. You assume all risk of use. [View Terms of Use](#)



Notes

Hwy 17 south of Moffat, CO at Mile Marker 103.

Map of:

Latitude: 37.96319 Longitude: -105.916401 Center, CO 81125

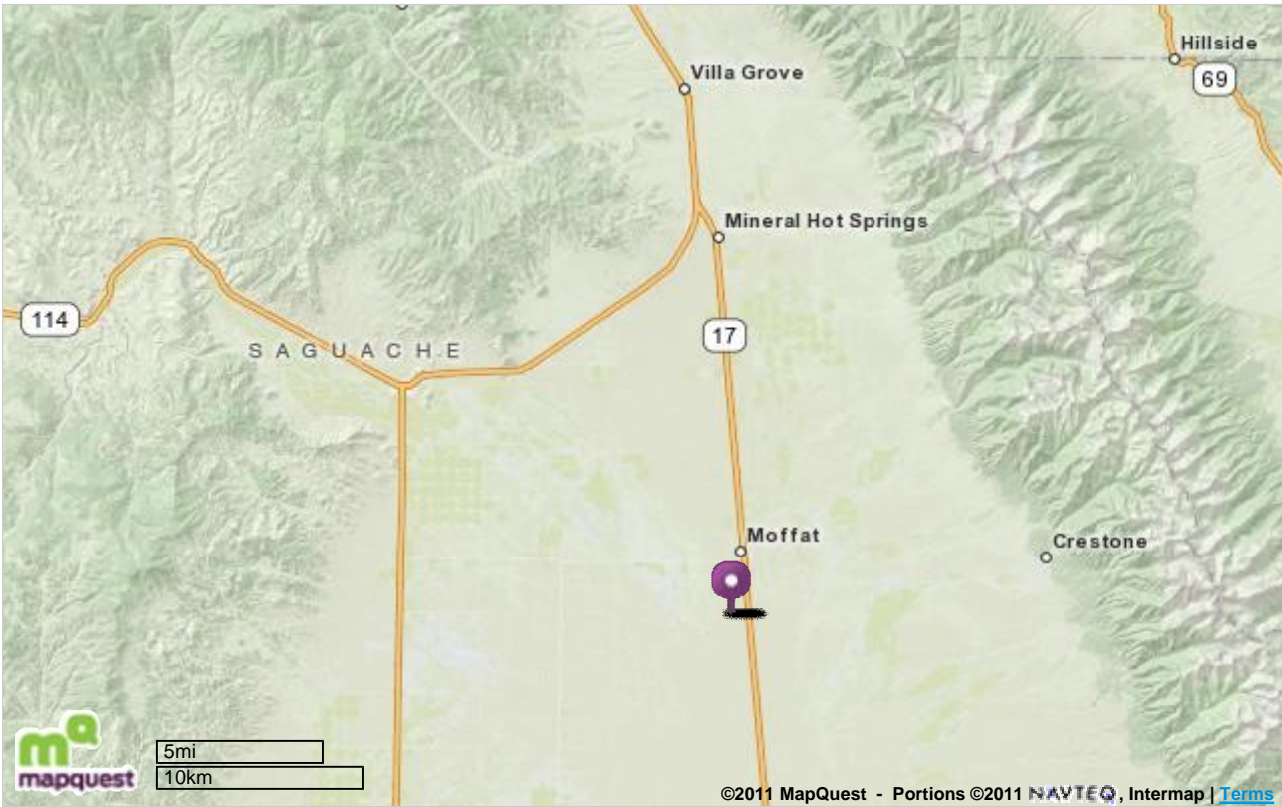

©2011 MapQuest, Inc. Use of directions and maps is subject to the MapQuest Terms of Use. We make no guarantee of the accuracy of their content, road conditions or route usability. You assume all risk of use. [View Terms of Use](#)



Notes

Hwy 17 south of Moffat, CO at Mile Marker 103.

Map of:

Latitude: 37.96319 Longitude: -105.916401
Center, CO 81125



©2011 MapQuest, Inc. Use of directions and maps is subject to the MapQuest Terms of Use. We make no guarantee of the accuracy of their content, road conditions or route usability. You assume all risk of use. [View Terms of Use](#)

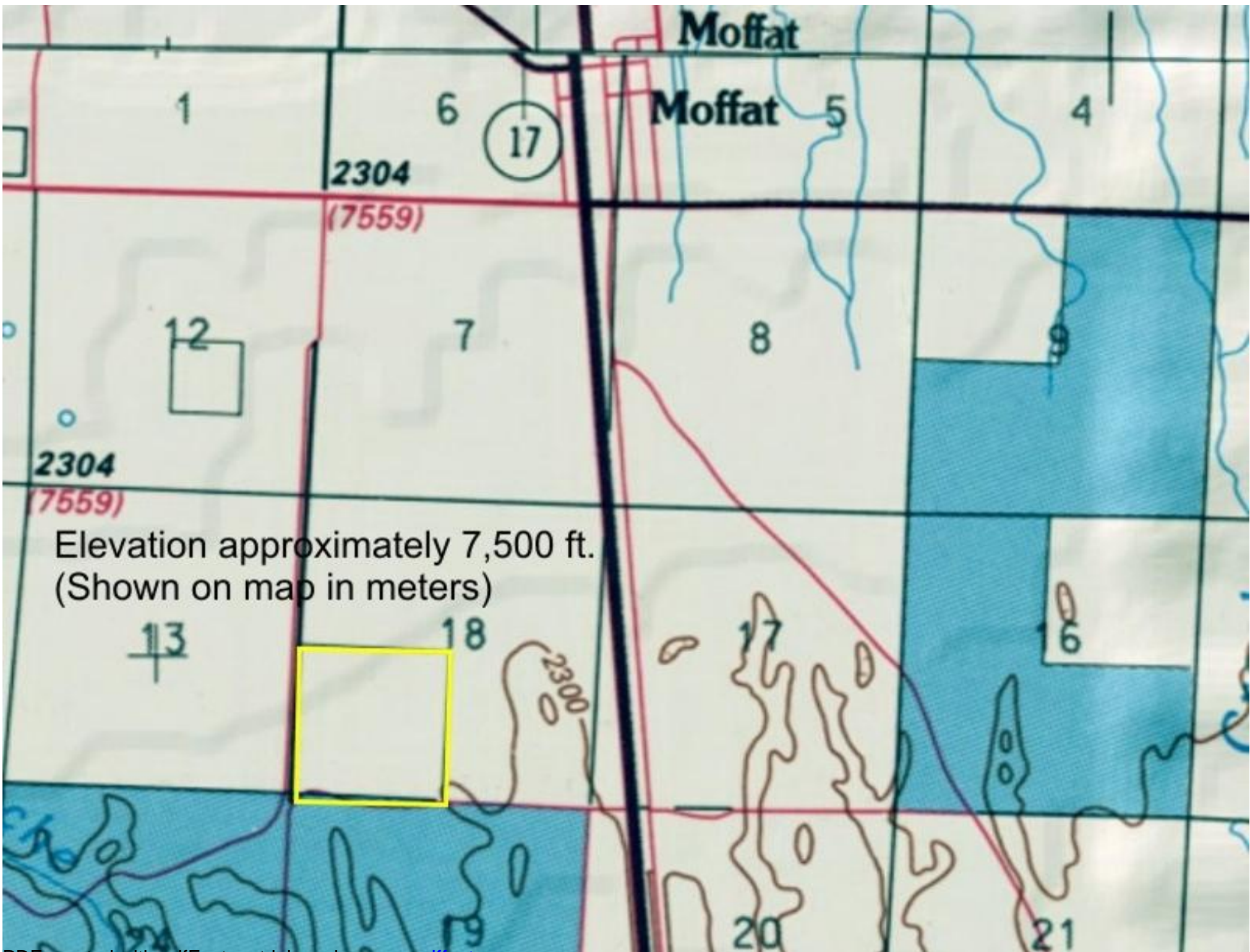

Moffat

Moffat

2304

(7559)

2304

(7559)

Elevation approximately 7,500 ft.
(Shown on map in meters)

2300

